

T7506E, F, T7005B, T7006E, F, T7007 B, and T7008B Electronic Temperature Sensors

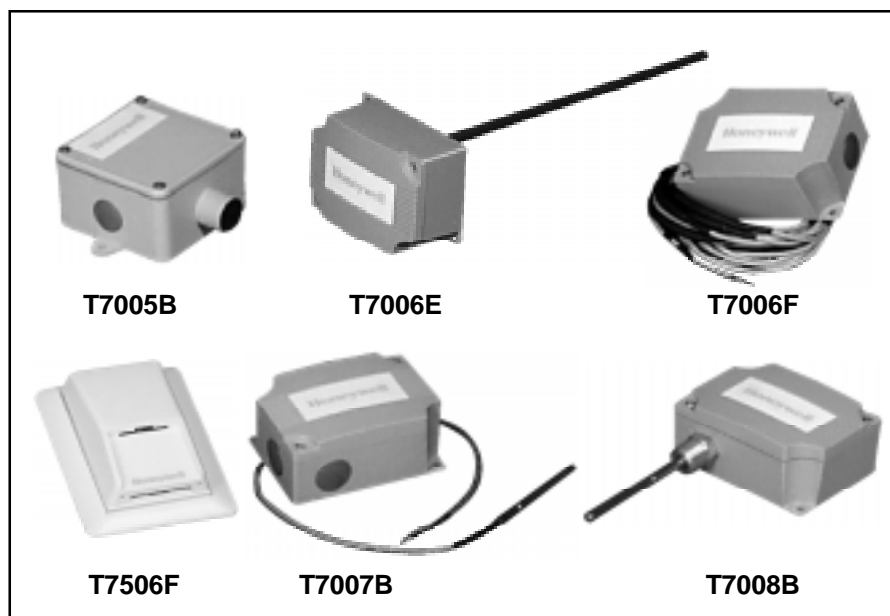

SPECIFICATION DATA



FEATURES

- Fast response.
- Precise temperature measurement.
- EXCEL 5000®, DELTA and DeltaNet system compatibility.

GENERAL

The T7506, T7005, T7006, T7007 and T7008 are 1000 ohm platinum resistance temperature detectors (RTD's), that sense temperature in electronic HVAC systems. They are designed for a variety of media such as air, liquid and steam, and can be used with Excel Plus, and Excel 5000 systems and with DeltaNet DDC Systems. All sensors are Honeywell brand labeled.

Sensors are available in different housings for space, surface, duct, immersion, duct averaging, strap-on and outside air applications.

SPECIFICATIONS

Models:

T7506 E Space Sensor

The T7506 E is a base plate wall mounted sensor suitable for use with a variety of Honeywell covers. The sensor is shipped with dust cover only.

T7506 F Space Sensor:

The T7506 F is a wall mounted sensor complete with designer cover.

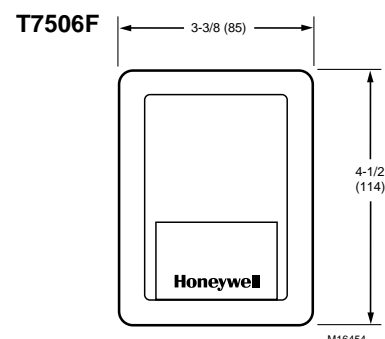
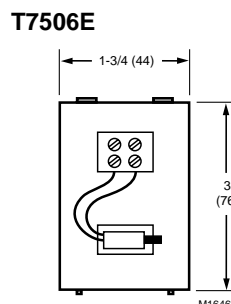

T7005 B Outside Air Sensor:

The T7005 B sensor is housed in a PVC weatherproof enclosure. The platinum sensing element is protected by a sun/wind shield.

T7006 E Duct Sensor:

The T7006 E duct sensor measures air temperature in a duct. The platinum sensing element is in the tip of a stainless steel probe.

- 200mm (8 in.) probe
- “A” • 300mm (12 in.) probe
- 450 mm (18 in.) probe

T7006 F Duct Averaging Sensor:

The T7006 F is a duct averaging temperature sensor of a totally flexibly plenum rated (CSA FT6) cable which incorporates numerous sensors at equal distances across its length acting as a single sensor.

- 1820mm (6 ft.) cable
- “B” • 3660mm (12 ft.) cable
- 6000mm (20 ft.) cable

T7007 B Strap-on Sensor:

The T7007 B is a remote probe that can be strapped on a pipe or any other application in which temperature is measured.

T7008 B Immersion Sensor:

The T7008 B Immersion sensor is encapsulated in a spring-loaded probe that can be fitted directly into any thermowell providing contact with the bottom of the thermowell.

- “C” • 100mm (4 in.) probe
- 150mm (6 in.) probe

Sensing Element:

1,000 ohm Platinum ± 1.2 ohm, DIN IEC 751
.00385 ohms/ohm/°C, thin film, 2-wire. Positive Temperature Coefficient.

Operating Range -40 to +100°C. (-40 to 212 F)

Humidity: 5 to 95 RH non-condensing

Accessories

T7506 E Space Sensor:

Brushed Aluminum Cover 14001984-500

Satin Chrome Plastic Cover 14004406-300

T7008 B Immersion Sensor:

Brass Well 100mm 40761553-001

Brass Well 150mm 40761554-001

Stainless Steel Well 100mm 40761555-001

Stainless Steel Well 150mm 40761556-001

T7005B

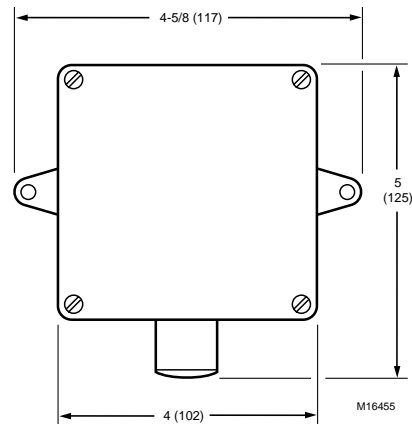

T7006E

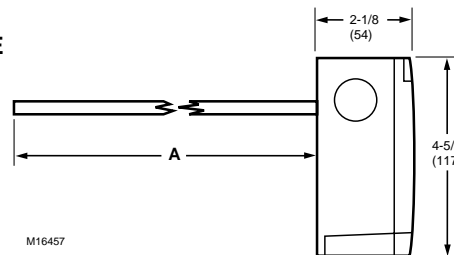

T7006F

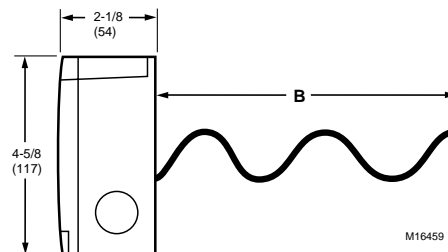

T7007B

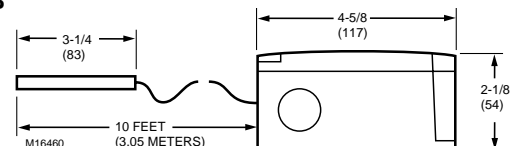

T7008B

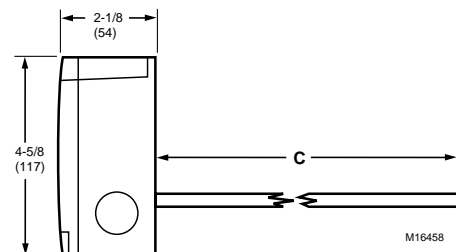

Honeywell

Home and Building Control

Honeywell Inc.
Honeywell Plaza
P.O. Box 524
Minneapolis MN 55408-0524

Home and Building Control

Honeywell Limited-Honeywell Limitée
155 Gordon Baker Road
North York, Ontario
M2H 3N7