

F6125HD Technical Data Sheet

Resilient Seat, 304 Stainless Steel Disc



Technical Data	
Fluid	chilled, hot water, up to 60% glycol
Flow characteristic	modified equal percentage
Controllable flow range	90° rotation
Valve Size [mm]	5" [125]
Pipe connection	for use with ANSI class 125/150 flanges
Housing	Ductile cast iron ASTM A536
Body finish	epoxy powder coating (blue RAL 5002)
Stem	416 stainless steel
Stem seal	EPDM (lubricated)
Seat	EPDM
Bearing	RPTFE
Disc	304 stainless steel
Body Pressure Rating	ANSI Class Consistent with 125, 232 psi CWP
ANSI Class	Consistent with 125
Number of Bolt Holes	8
Lug threads	3/4-10 UNC
Close-off pressure Δ ps	200 psi
Rangeability Sv	10:1 (for 30° to 70° range)
Maximum Velocity	12 FPS
Cv	1022
Weight	17 lb [7.5 kg]
Fluid Temp Range (water)	-22...250°F [-30...120°C]
Leakage rate	0%
Maintenance	maintenance-free

Flow/Mounting Details

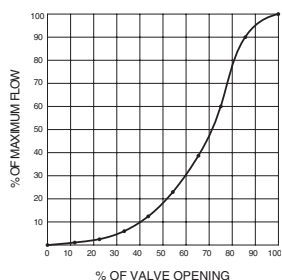

Application

Valve is designed for use in ANSI flanged piping systems to meet the needs of bi-directional high flow HVAC hydronic applications with 0% leakage. Typical applications include cooling tower bypass, primary flow change-over systems, and large air-handler coil control. Valve face-to-face dimensions comply with API 609 & MSS-SP-67, Completely assembled and tested, ready for installation.

Jobsite Note

Valve assembly should be stored in a weather protected area prior to installation. Reference the butterfly valve installation instruction for additional information.

Flow/Cv								
Cv 10°	Cv 20°	Cv 30°	Cv 40°	Cv 50°	Cv 60°	Cv 70°	Cv 80°	Cv 90°
0.5	29	61	133	237	392	620	930	1022

Suitable Actuators

	Non-Spring	Electronic fail-safe
F6125HD	DRB(X), PRB(X)	PKRB(X)

Dimensions (Inches [mm])

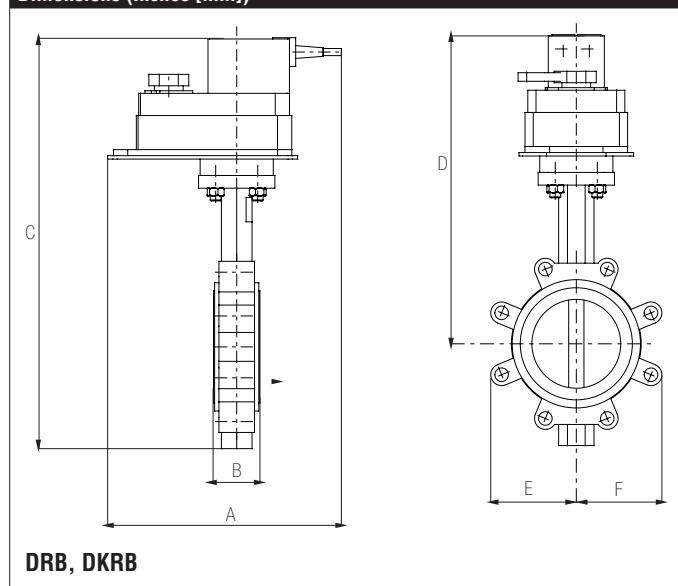

DRB, DKRB

A	B	C	D	E	F
11.3" [286]	2.3" [58]	17.9" [454]	13.6" [345]	4.9" [124]	4.9" [125]

Safety Notes

WARNING: For Belimo products sold in California: these products do or may contain chemicals which are known to the State of California to cause cancer and or birth defects or other reproductive harms. For more information see www.p65warnings.ca.gov.

Dimensions (Inches [mm])

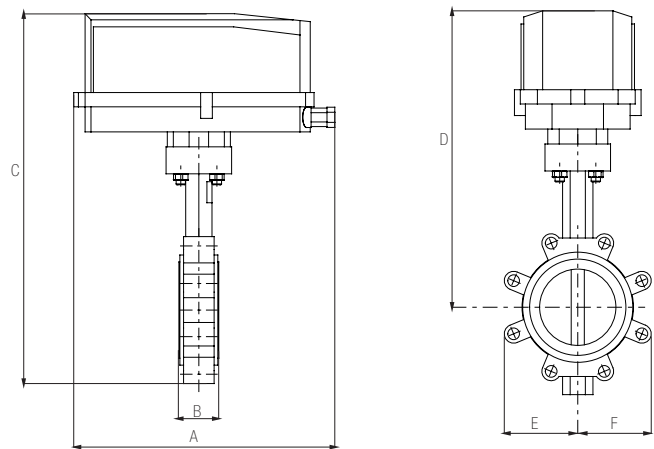

DRB..N4(H), DKRB..N4(H)

A	B	C	D	E	F
14.1" [358]	2.3" [58]	20.0" [509]	15.7" [399]	4.9" [124]	4.9" [125]

Dimensions (Inches [mm])

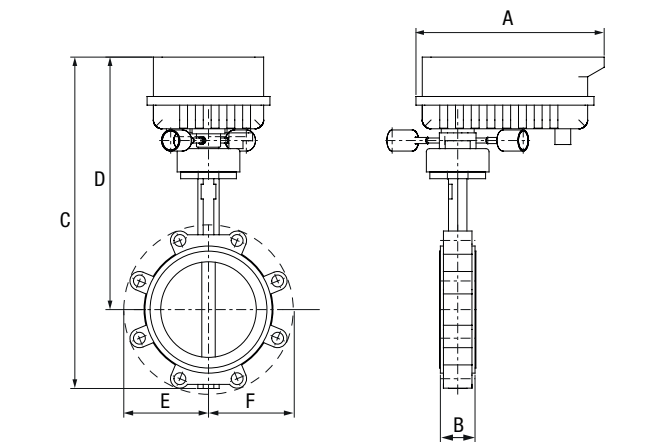

PRB, PRX

A	B	C	D	E	F
12.0" [304]	2.2" [56]	19.9" [506]	15.5" [394]	4.9" [124]	4.9" [125]

F6125HD Technical Data Sheet

Resilient Seat, 304 Stainless Steel Disc

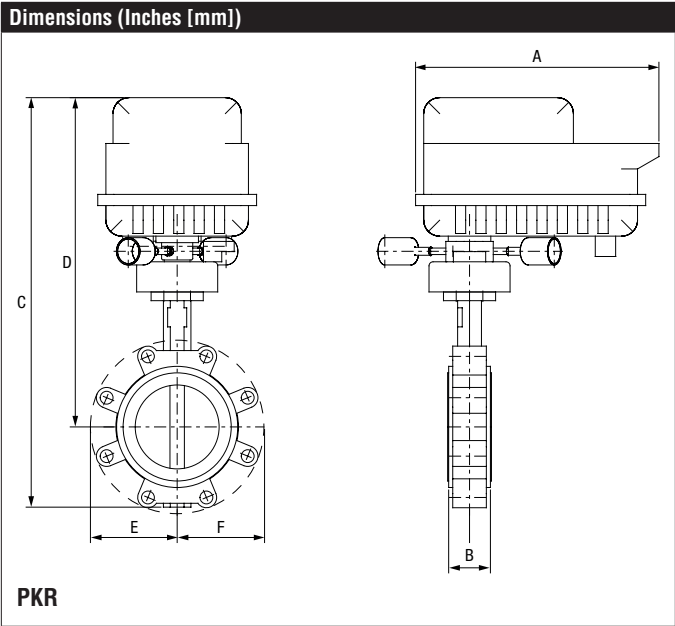

A	B	C	D	E	F
12.0" [304]	2.2" [56]	22.1" [562]	17.8" [453]	4.9" [124]	4.9" [125]

Date created, 09/11/2019 - Subject to change. © Belimo Aircontrols (USA), Inc.

DKRX24-3-T Technical Data Sheet

On/Off, Floating Point, Electronic Fail-Safe, 24 V



5-year warranty



Technical Data

Power Supply	24 VAC, $\pm 20\%$, 50/60 Hz
Power consumption in operation	12 W
Power consumption in rest position	3 W
Transformer sizing	21 VA (class 2 power source)
Electrical Connection	Terminal blocks
Overload Protection	electronic throughout 0...90° rotation
Torque motor	810 in-lb [90 Nm]
Direction of rotation motor	reversible with built-in switch
Direction of motion fail-safe	reversible with switch
Position indication	Mechanically, integrated, two-section
Manual override	external push button
Running Time (Motor)	default 150 s, variable 90...150 s
Running time fail-safe	<35 s
Ambient humidity	max. 95% r.H., non-condensing
Ambient temperature	-22...122°F [-30...50°C]
Storage temperature	-40...176°F [-40...80°C]
Degree of Protection	IP54, NEMA 2, UL Enclosure Type 2
Housing material	Polycarbonate
Noise level, motor	45 dB(A)
Noise level, fail-safe	50 dB(A)
Servicing	maintenance-free
Quality Standard	ISO 9001
Weight	3.2 lb [1.5 kg]

Safety Notes

WARNING: This product can expose you to lead which is known to the State of California to cause cancer and reproductive harm. For more information go to www.p65warnings.ca.gov

Wiring Diagrams

✂️ INSTALLATION NOTES

- 1 Provide overload protection and disconnect as required.
- 10 For triac sink the Common connection from the actuator must be connected to the Hot connection of the controller. Position feedback cannot be used with a triac sink controller; the actuator internal common reference is not compatible.
- 11 Actuators may be connected in parallel if not mechanically linked. Power consumption and input impedance must be observed.
- 12 IN4004 or IN4007 diode. (IN4007 supplied, Belimo part number 40155).
- 16 Actuators are provided with a numbered screw terminal strip instead of a cable.
- Meets cULus requirements without the need of an electrical ground connection.

⚠️ WARNING! LIVE ELECTRICAL COMPONENTS!
During installation, testing, servicing and troubleshooting of this product, it may be necessary to work with live electrical components. Have a qualified licensed electrician or other individual who has been properly trained in handling live electrical components perform these tasks. Failure to follow all electrical safety precautions when exposed to live electrical components could result in death or serious injury.

